

SVGA HD15 M/M with Disconnect 50.0 ft

Features for this product

- SVGA video signal transmission in difficult routing situations
- Low profile disconnect and HD15 backshell allows routing through 3/4" conduit
- User defined hardware results in maximum mounting flexibility
- Three 75 Ohm coaxial cables assure optimum video signal transmission
- Available in 5 standard lengths from 15 to 75 ft



Now there is a solution to your difficult installation problems. This series features a fully populated DDC compliant assembly with (2) low profile HD15 male connectors and our Super Thin cable. An additional feature of this series is our unique user defined mounting hardware plus a low profile break connector. The low profile disconnect connector's small size allows routing through 3/4" conduit and other tight spaces that would not accommodate the size of a HD15 connector. Offered in standard lengths of 15, 20, 25, 50 and 75 feet with a 1 foot lead in length to the low profile connector.

Details for this Monitor, Video product

L-com Item #	CTLB3VGAMM-50T
Manufacturer	L-com
UPC #	822335018310
RoHS Status	Partially RoHS Compliant Stock 

Standard vs. Ultra-flex video

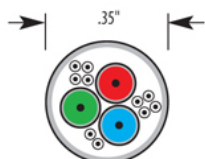

Standard video cabling with standard coaxials

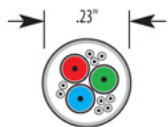

NEW Super Thin video cabling with micro coaxials

Fits through 3/4" conduit

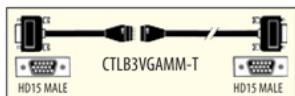

Item #	Description	#Coax
--------	-------------	-------

SVGA Cables with Low Profile Disconnect Feature - HD15 Male to HD15 Male

Now there is a solution to your difficult installation problems. A fully populated DDC compliant assembly with (2) HD15 male connectors utilizing our Super Thin cable, reversible hardware plus a low profile break connector. The low profile break connector's small size (.75" wide) allows routing through 3/4" conduit and through tight spaces that would not accommodate the size of a HD15 connector. Color: Black.

CTLB3VGAMM-15T	Super Thin SVGA Cable, HD15 Male / Male, 15.0 ft	3
CTLB3VGAMM-20T	Super Thin SVGA Cable, HD15 Male / Male, 20.0 ft	3
CTLB3VGAMM-25T	Super Thin SVGA Cable, HD15 Male / Male, 25.0 ft	3
CTLB3VGAMM-50T	Super Thin SVGA Cable, HD15 Male / Male, 50.0 ft	3
CTLB3VGAMM-75T	Super Thin SVGA Cable, HD15 Male / Male, 75.0 ft	3

Plenum Jacket SVGA Cables with Low Profile Disconnect Feature - HD15 Male to HD15 Male

This series is identical to our SVGA cables with one important exception, the outer jacket is made from CMP grade plenum material for applications where fire resistance and low smoke characteristics are critical. Color: Black.

CTLB3VGAMM-15TP	Super Thin Plenum SVGA Cable, HD15 Male / Male, 15.0 ft	3
CTLB3VGAMM-20TP	Super Thin Plenum SVGA Cable, HD15 Male / Male, 20.0 ft	3
CTLB3VGAMM-25TP	Super Thin Plenum SVGA Cable, HD15 Male / Male, 25.0 ft	3
CTLB3VGAMM-50TP	Super Thin Plenum SVGA Cable, HD15 Male / Male, 50.0 ft	3
CTLB3VGAMM-75TP	Super Thin Plenum SVGA Cable, HD15 Male / Male, 75.0 ft	3

LSZH Jacket SVGA Cables with Low Profile Disconnect Feature - HD15 Male to HD15 Male

This series features a fully populated DDC compliant assembly with (2) low profile HD15 male connectors and our low smoke zero halogen Super Thin cable. An additional feature is our unique user defined mounting hardware plus a low profile break connector which allows routing through 3/4" conduit and other tight spaces. Offered in standard lengths of 15, 20, 25, 50 and 75 feet with a 1 foot lead in length to the low profile connector.

CTLB3VGAMM-15TZ	Super Thin LSZH SVGA Cable, HD15 Male / Male, 15.0 ft	3
CTLB3VGAMM-20TZ	Super Thin LSZH SVGA Cable, HD15 Male / Male, 20.0 ft	3
CTLB3VGAMM-25TZ	Super Thin LSZH SVGA Cable, HD15 Male / Male, 25.0 ft	3
CTLB3VGAMM-50TZ	Super Thin LSZH SVGA Cable, HD15 Male / Male, 50.0 ft	3
CTLB3VGAMM-75TZ	Super Thin LSZH SVGA Cable, HD15 Male / Male, 75.0 ft	3



Tip Using CTLB series cable for running through 3/4" conduit



STEP 1
Feed socket end through conduit (3/4" min. dia.) into destination outlet.



STEP 2
Slip shrinkable tubing onto cable, mate the breakaway connector matching alignment arrows and secure.

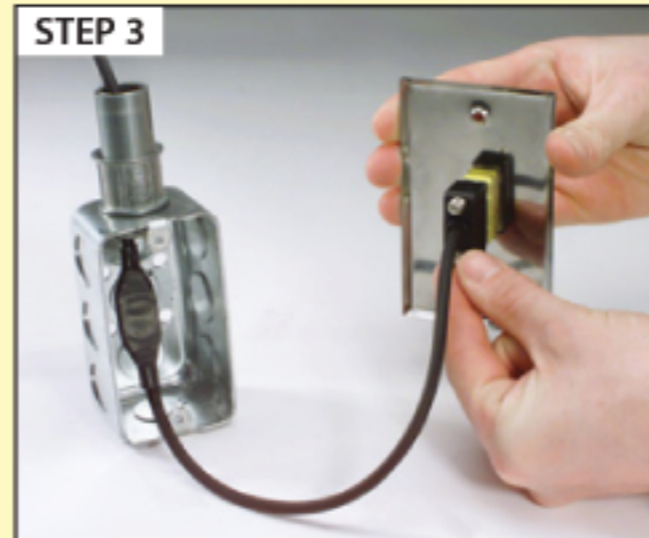

STEP 3
Attach pre-terminated HD15 connector to faceplate and attach to outlet.

Video Wallplate Assemblies

Combining our innovative field termination style HD15 and Mini DIN 4 (SVHS) as well as a HD15 female pigtail with our stainless steel wallplates L-com now offers a convenient series of preassembled wallplate assemblies for your field installation applications.

WPHD15FT	Wallplate Assembly, HD15 Female
WPMF44FT	Wallplate Assembly, MD44 (S-Video) Female
WPHD15C	Wallplate Assembly, HD15 Female to 5 BNC Female 2 ft Pigtail

Solder Type Mini DIN 4 Connectors with Metal Cover For SVHS Assemblies

BAC-MD4M	SVHS Mini DIN 4 Connector, Male
BAC-MD4F	SVHS Mini DIN 4 Connector, Female

Bulkhead Feed-Thru Adapter for SVHS Mini DIN 4 - Fits 1/2" Diameter D-hole

MD44F	Bulkhead Feed-Thru Adapter, Female / Female
-----------------------	---

Bulk SVGA Cable - Double Shielded with (3) 75 Ohm Coaxial Lines Plus Conductors

This is the same bulk cable used in our premium grade SVGA assemblies. The three coaxial lines are double shielded enhancing video performance. In addition the bulk cable construction includes four 26AWG twisted pairs and two 26AWG conductors. Used in conjunction with our D-Sub connectors you can now fabricate your own SVGA cable assemblies. Color: Black.

CTL3VGA-250	SVGA Bulk Cable, 250.0 ft
CTL3VGA-500	SVGA Bulk Cable, 500.0 ft

Bulk Super Thin SVGA Cable - Double Shielded - (3) 75 Ohm Coaxial Lines Plus Conductors

This is the same bulk cable used in our Thinline series SVGA assemblies. The three coaxial lines are double shielded enhancing video performance. In addition the bulk cable construction includes nine stranded 30AWG conductors. Used in conjunction with our D-Sub connectors you can now fabricate your own Super Thin SVGA cable assemblies.

CTL3VGA-250T	Super Thin SVGA Bulk Cable, 250.0 ft
CTL3VGA-500T	Super Thin SVGA Bulk Cable, 500.0 ft

SVHS Bulk Cable - Dual 75 Ohm Coaxials - High Flex Round PVC Jacket

R1088-100	Bulk S-Video Cable, 100.0 ft
R1088-500	Bulk S-Video Cable, 500.0 ft
R1088-1K	Bulk S-Video Cable, 1000.0 ft

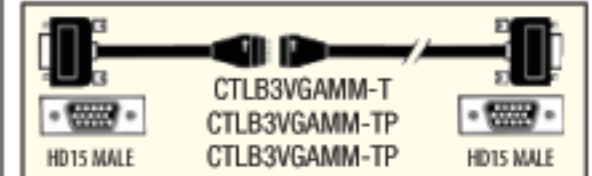

www.L-com.com/videos/A04

Fits through 3/4" conduit

